

GUARDIAN JR CLICK PEN KIT

KIT FEATURES

- Heavy plating with various finishes
- Wide rubber grip is easy to hold in a contemporary design.
- Convenient click mechanism with gel ink refill.
- Smaller diameter popular with most pen users.
- Parker™ style gel refill - #PKPARK-R5
- Overall length: 5-1/2"

REQUIRED ACCESSORIES:

- 7mm pen mandrel
- 8mm drill bit -#PKPARK-8mm
- 2 pc bushing set -#PKGDJRBU
- Universal barrel trimmer - PKTRIMKIT
- 2-part epoxy #PKGLUE2 or insta-cure (cyanoacrylate) glue

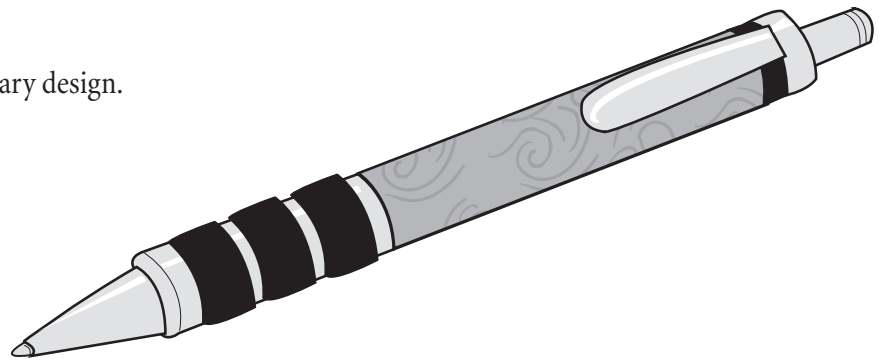

PREPARING THE BLANK

- Cut 3/4" or larger pen blank to the size of the brass tube (add 1/16" for trimming). Mark the center of the blank.
- Drill an 8mm hole through the blank. **NOTE:** Sand tubes with 220 grit abrasive for better adhesion.
- Spread glue over tube and insert the tube into the blank with a twisting motion to spread the glue evenly inside, centering the tube in the blank.
- When the glue dries, trim the ends of the blank. Trim the excess wood down to the brass tube.

DIAGRAM A / Parts list

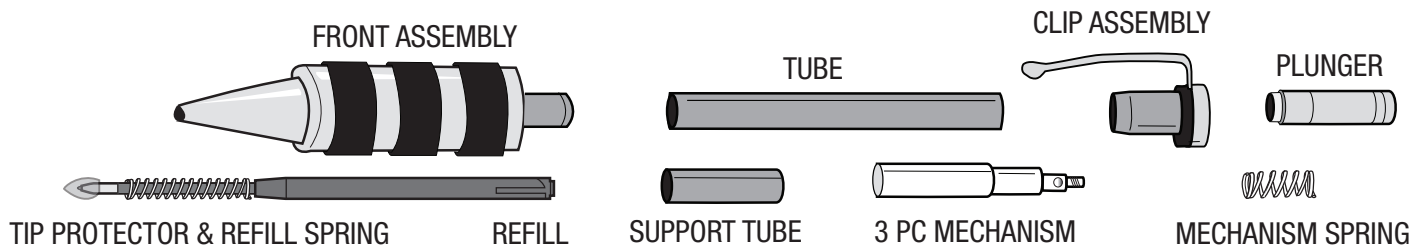

TURNING THE BLANK

- Place 7mm spacer bushings onto the mandrel followed by the first bushing, wide end in first. Place the barrel over the bushing. Slide on the second bushing, narrow end first. Add spacer bushings as necessary. Thread on the lock nut; hand tight over the mandrel shaft. Bring the tailstock snug to the mandrel and lock it in place. Tighten the lock nut for turning. Do not over tighten the nut, it could damage the mandrel.
- Turn the wood down in a straight profile and sand to the bushing diameter.
- Finish the wood with your choice of polish.

DIAGRAM B / Turning the blank

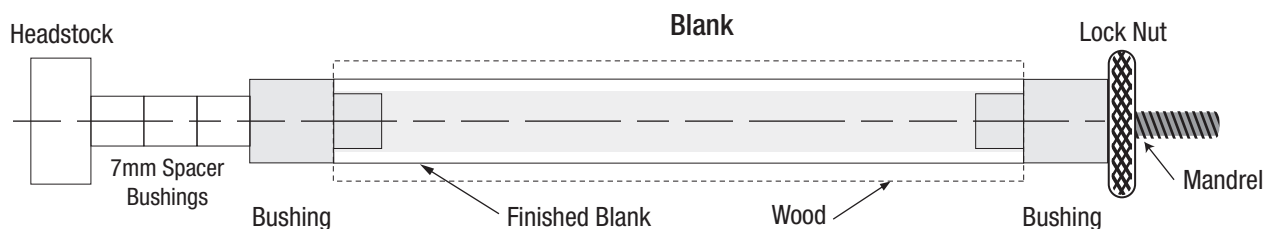
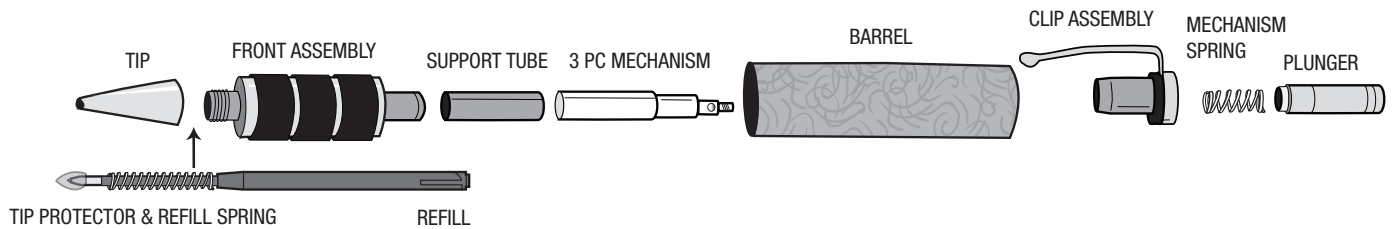
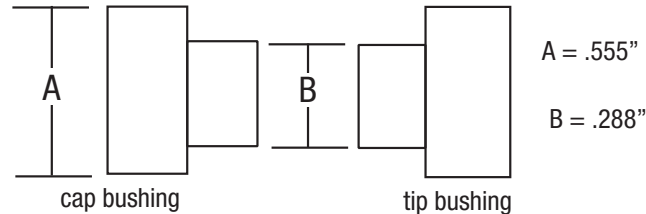

DIAGRAM C / Pen assembly**PEN ASSEMBLY**

NOTE: Line up the components according to Diagram 'C'. To avoid damage to components when assembling the pen, use a vise with covered jaws or #PENPRESS4.

- Insert the 3 piece mechanism, threaded end in first into either end of the barrel. Followed with the support tube.
- Insert the front assembly into the barrel, press in.
- Insert the clip assembly into the opposite end of the barrel, press in.
- Pull the tip protector off the refill; slide the refill spring over the tip of the refill.
- Unscrew the tip. Insert the refill into the opening. Thread the pen tip back on to the front assembly.
- Drop the mechanism spring into the opposite end of the pen.
- Screw on the plunger over the mechanism threads to the bottom.

The pen is ready to operate by clicking the plunger to extend or retract the refill.

DIAGRAM D • #PKGDJRBU

NOTE: Bushings are the same size.