

Over & Under Roller & Fountain Pen Kits

KIT FEATURES

- Pen represents the popular over/under style shotgun
- Simulated 12ga. shotgun cap
- Simulated .30ml bullet cartridge body
- Roller Ball uses Premium Refill #PK10-RPR
- Fountain Pen uses German made Iridium Tip nib
- Overall length: 6 1/2"
- Rose Gold Tip
- Uses a wood color for the cap to simulate 12g. shotgun

KIT REQUIRED ACCESSORIES

- 7mm, Pen Mandrel
- 3 pcs. bushing set #PKCP6000BU
- 9/16" Drill bit #FB916 for the upper blank
- 12.5mm drill bit #PKPLI-DB for the lower blank
- Trimming Sleeves #PKAPBTS (use with 7mm barrel trimmer shaft)
- 2 Part epoxy glue or Insta Cure (cyanoacrylate)
- Extra tubes #PKCP6000TU (2 Sets)

DIAGRAM A / B – ROLLER/FOUNTAIN PEN PARTS

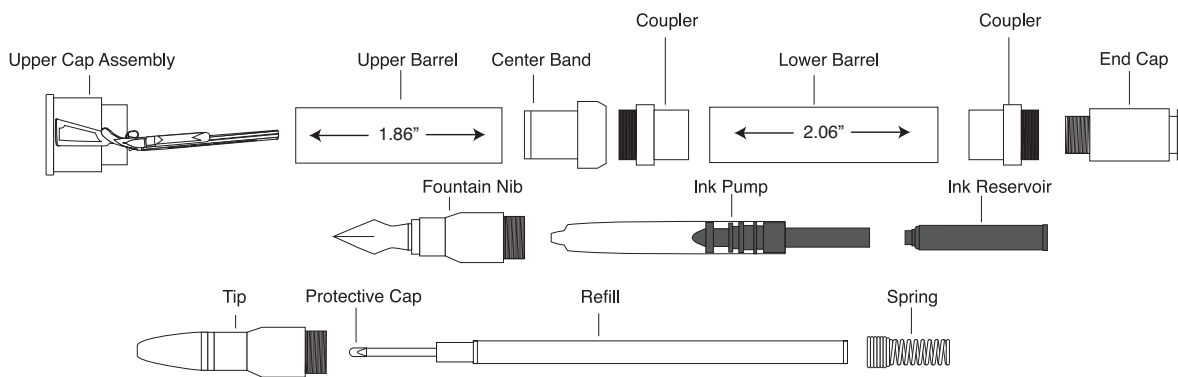

PREPARING THE BLANKS

- Cut 3/4" or larger pen blanks to the size of the brass tubes (add 1/16" for trimming).
- Drill a 9/16" diameter hole through the upper blank (shorter).
- Drill a .492" diameter hole through the lower blank (longer).
- Spread glue over tubes. Insert each into the proper barrel with a twisting motion to spread the glue evenly in side.
- When the glue dries, trim the ends of each blank. Use a 7mm barrel trimmer with adapter sleeves (#PKAPBTS). Take the excess wood down to the brass tube.

DIAGRAM C – TURNING THE BLANKS

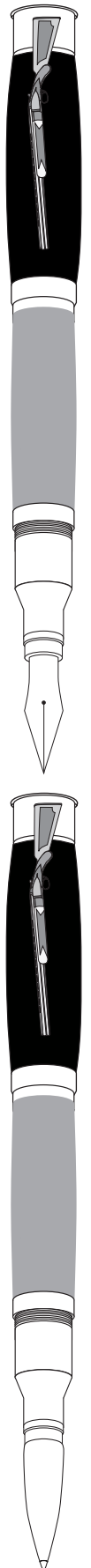
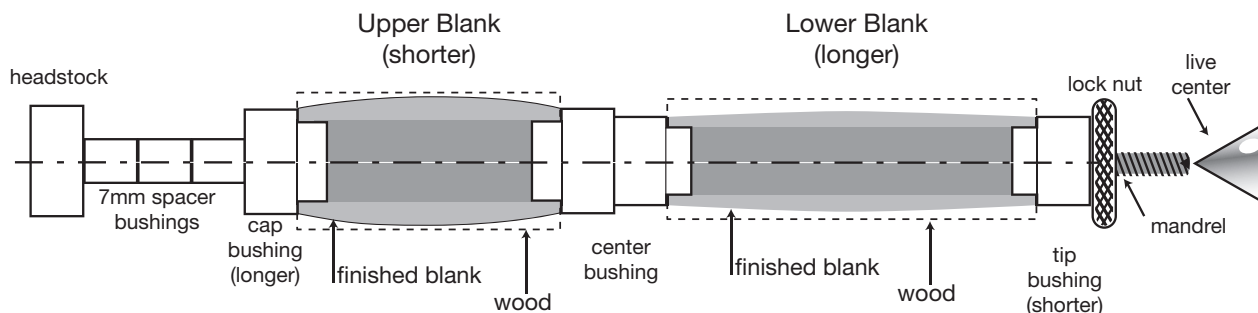

TURNING THE BLANKS

- Slide spacer bushing onto the mandrel shaft, followed by the longer bushing, wide end in first. Slide on the upper blank (shorter). Add the center bushing, wider section in first. Add the center bushing, wider section in first. Place the lower blank (longer) followed by the shorter end bushing, smaller end first. Add Additional spacer bushings as necessary to reach the mandrel shaft threads.
- Thread on the lock-nut hand tight. Bring the tailstock in snug to the mandrel, lock in place. Tighten the lock nut for turning. Do over tighten the lock-nut, it could damage the mandrel.
- Turn the barrels close to the bushing diameter with sharp tools; sand the barrels to match the bushing diameter.
- Finish the wood with your choice of polish.

DIAGRAM D1 / D2 - FOUNTAIN PEN / ROLLER BALL

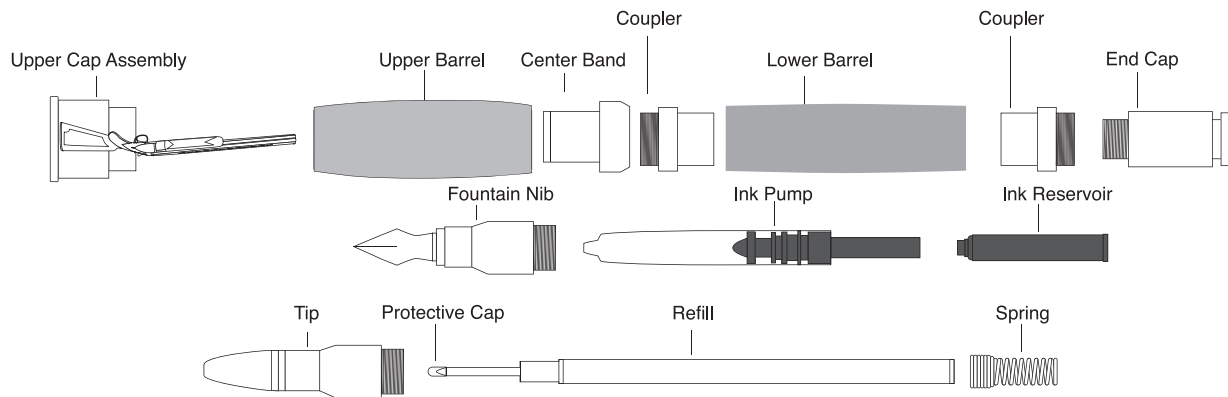

ASSEMBLY

NOTE: Line up the components according to Diagram D1 & D2

- Insert the upper cap assembly, narrow end first into the upper barrel, press in.
- Insert the center band, narrow end in first into the opposite end of the barrel.

- Press each coupler, narrow end first into the openings at the lower barrel
- Affix the end cap into either one of the couplers

FOUNTAIN PEN

- Insert the ink cartridge narrow end first into the opening at the rear of the fountain tip assembly. Press the lightly to advance the link forward to the nib.
- Thread the fountain nip assembly on to the coupler.
- To use the refillable pump. Just mount the clear end of the pump into the nib assembly. Turn the black knob until the piston is down. Insert the nib into an inkwell. Turn clock wise to draw ink into the pump.

ROLLER BALL

- Drop the refill spring into the barrel.
- Discard the protective cap from the refill. Insert the refill, wide end in first into the opening.
- Thread the roller tip into the coupler.
- The roller ball pen is ready to operate.

BUSHINGS

